

# KVT-W90 | Split 90° cable gland

for cables with connectors, M32/M50 / IP54



The split KVT-W90 cable glands are used to insert and seal pre-terminated cables at a 90° angle. But also electric, pneumatic or hydraulic lines without terminals or connectors as well as corrugated conduits can be easily routed (e.g. into control panels, enclosures or machinery) and sealed with IP54.

In particular, the KVT 50-W90 is perfectly suited to hold corrugated or smooth hoses. A large number of cable entry grommets is available to the user. By using [multi-hole grommets](#) up to 16 lines can be routed with one cable gland.

Polyamide standard locknuts as well as a sealing ring are included in the shipment. [Split locknuts](#) can be ordered separately.

IP54

RoHS compliant

C<sup>RU</sup>US

REACH COMPLIANCE

DNV

DNV GL

HL3

EN 45545-2

ECOLAB

certified

Made in Germany

## Specifications

IP rating (EN 60529)	IP54
Material	Polycarbonate
Flame class	UL94-V0, self-extinguishing
Operating temperature	-30 C° to 100 C°
Properties	halogen free, silicone free
Mounting options	Fasten with locknut

## Advantages & Benefits

- Installation at an angle of 90° to the wall
- Routing of cables with and without connectors
- Warranty on pre-terminated cables remains
- Suitable for metric cut-outs
- Hexagonal locknut included in the delivery

## Product Types & Sizes

	KVT 32-W90 gy	Part No.	45404	Mounting height	26 mm
		EAN	4251269311406	Cut-out size, metric	M32
		Package quantity	10	Cut-out size, round	32,3 mm
		For max. no. of cables	4	Thread	M32 x 1,5
		Max. cable diameter	17 mm	Thread length	11,5 mm
		Color	gray (similar RAL 7035)	Suitable for grommets	1 x KT small
		Height	40 mm		

	KVT 32-W90 bk	Part No.	45406	Mounting height	26 mm
		EAN	4251269311413	Cut-out size, metric	M32
		Package quantity	10	Cut-out size, round	32,3 mm
		For max. no. of cables	4	Thread	M32 x 1,5
		Max. cable diameter	17 mm	Thread length	11,5 mm
		Color	black	Suitable for grommets	1 x KT small
		Height	40 mm		

KVT 50|4-W90 gy

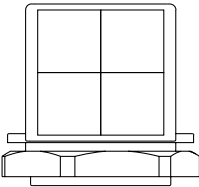

Part No.	<b>45424</b>	Mounting height	<b>46,5 mm</b>
EAN	<b>4251269311444</b>	Cut-out size, metric	<b>M50</b>
Package quantity	<b>5</b>	Cut-out size, round	<b>50,4 mm</b>
For max. no. of cables	<b>16</b>	Thread	<b>M50 × 1,5</b>
Max. cable diameter	<b>17 mm</b>	Thread length	<b>11,5 mm</b>
Color	<b>gray (similar RAL 7035)</b>	Suitable for grommets	<b>4 x KT small</b>
Height	<b>61 mm</b>		

KVT 50|4-W90 bk

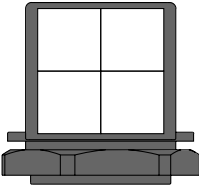

Part No.	<b>45426</b>	Mounting height	<b>46,5 mm</b>
EAN	<b>4251269311451</b>	Cut-out size, metric	<b>M50</b>
Package quantity	<b>5</b>	Cut-out size, round	<b>50,4 mm</b>
For max. no. of cables	<b>16</b>	Thread	<b>M50 × 1,5</b>
Max. cable diameter	<b>17 mm</b>	Thread length	<b>11,5 mm</b>
Color	<b>black</b>	Suitable for grommets	<b>4 x KT small</b>
Height	<b>61 mm</b>		

KVT 50|1-W90 gy

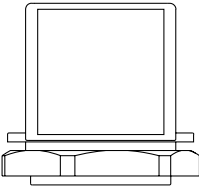

Part No.	<b>45414</b>	Mounting height	<b>46,5 mm</b>
EAN	<b>4251269311420</b>	Cut-out size, metric	<b>M50</b>
Package quantity	<b>5</b>	Cut-out size, round	<b>50,4 mm</b>
For max. no. of cables	<b>1</b>	Thread	<b>M50 × 1,5</b>
Max. cable diameter	<b>35 mm</b>	Thread length	<b>11,5 mm</b>
Color	<b>gray (similar RAL 7035)</b>	Suitable for grommets	<b>1 x KT large</b>
Height	<b>61 mm</b>		

KVT 50|1-W90 bk

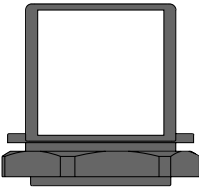

Part No.	<b>45416</b>	Mounting height	<b>46,5 mm</b>
EAN	<b>4251269311437</b>	Cut-out size, metric	<b>M50</b>
Package quantity	<b>5</b>	Cut-out size, round	<b>50,4 mm</b>
For max. no. of cables	<b>1</b>	Thread	<b>M50 × 1,5</b>
Max. cable diameter	<b>35 mm</b>	Thread length	<b>11,5 mm</b>
Color	<b>black</b>	Suitable for grommets	<b>1 x KT large</b>
Height	<b>61 mm</b>		